

Chandra Fastener Agencies LLC



Chandra Engineering Agencies is one of the leading dealers of Industrial Fasteners in Chennai (India) for over 3 decades. We mainly focus on wholesale trade servicing leading industries in South India.

Chandra Fastener Agencies LLC is from the same group in United States of America. The prime focus is to service local fasteners requirement through Import.



Mission Statement

Commit to provide best service to our global customers with timely supply, customer support and economical pricing.



Key focus areas of our business

- ❖ Quality
- ❖ Cost
- ❖ Timely delivery
- ❖ Customized Service



Fastener Lines

- ❖ Standard Hexagon Head Screws / Bolts
- ❖ Anchor Fasteners
- ❖ Nuts – Standard Hex / Slotted / Castle / Weld / Nyloc and Specials
- ❖ Flange screws & bolts
- ❖ Socket Products - Head cap screws, Shoulder screws, CSK screws, Button head screws, Set screws, Wrench keys, T-handle keys
- ❖ Cross recessed, self tapping and metal screws
- ❖ Some Automobile and Special Industrial Fasteners as well



Key Services

- ❖ Dealer of leading Indian Fastener Manufacturers
- ❖ Fastener Import from reliable and economic source
- ❖ Just-in-time supply
- ❖ Lot traceability
- ❖ Material Certification

Chandra Engineering Agencies

19, 1st Floor, General Patters Road
Chennai, Tamil Nadu 600 002
INDIA

Off: +91-44-2860 0401

Fax: +91-44-2860 0022

Chandra Fastener Agencies LLC

24082 Hollyoak, Unit F
Aliso Viejo, CA 92656
USA

Off: +1-949-295 3886

Fax: +1-949-273 5000

Email: sales@chandraengg.com Web: www.chandraengg.com

Kindly Note: We also deal with other fasteners, material, specification and range not listed here.
Please contact us for specific detail. Thank You!

Socket Head Cap Screw

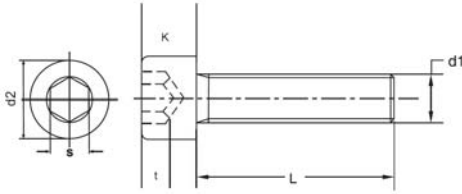

Tolerances	ISO 4759 & ISO 286-2
Threads	6g-1ISO 965
Material	AISI 304, 316; Class 4.6, 8.8, 10.9, 12.9
Length (L)	5 to 200 mm

Dimension Standard: DIN 7991

(d1)	M3	M4	M5	M6	M8	M10	M12	M16	M20	M24
Pitch	0.5	0.7	0.8	1.0	1.25	1.5	1.75	2.0	2.5	3.0
Head Dia (d2)	5.5	7	8.5	10	13	16	18	24	30	36
Head Height (K)	3	4	5	6	8	10	12	16	20	24
A/F (S)	2.5	3	4	5	6	8	10	14	17	19
Socket Depth (t)	1.3	2	2.5	3	4	5	6	8	10	12

Dimension Standard: ANSI B 18.3

(d1)	3/16"	1/4"	5/16"	3/8"	1/2"	5/8"	3/4"	1"
Pitch - UNC	24	20	18	16	13	11	10	8
Head Dia max (d2)	7.9	9.53	11.10	14.30	19.05	23.80	33.30	38.00
Head Height max (K)	4.74	6.35	7.92	9.52	12.7	15.88	19.05	25.4
A/F (S)	5/32	3/16	7/32	5/16	3/8	1/2	5/8	3/4

Socket Button Head Screw

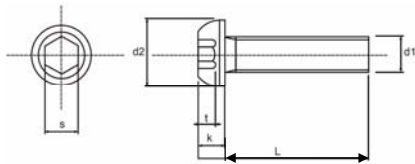

Tolerances	ISO 4759 & ISO 286-2
Threads	6g-1ISO 965
Material	AISI 304, 316; Class 4.6, 8.8, 10.9, 12.9
Length (L)	6 to 150 mm

Dimension Specification: ISO 7380

(d1)	M2	M2.5	M3	M4	M5	M6	M8	M10	M12
Head Dia max (d2)	3.5	4.5	5.7	7.6	9.5	10.5	14	17.5	21
Head Height max (k)	1.3	1.5	1.65	2.2	2.75	3.3	4.4	5.5	6.6
Socket A/F (S)	1.3	1.5	2	2.5	3	4	5	6	8
Socket Depth Min (t)	0.6	0.8	1.04	1.3	1.56	2.08	2.6	3.12	4.16

Socket CSK Screw

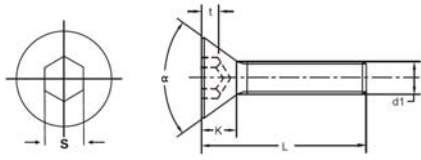

Tolerances	ISO 4759 & ISO 286-2
Threads	6g-ISO 965
Material	AISI 304, 316; Class 4.6, 8.8, 10.9, 12.9
Length (L)	6 to 150 mm

Dimension Standard: DIN 7991

(d1)	M3	M4	M5	M6	M8	M10	M12	M16	M20	M24
Pitch	0.5	0.7	0.8	1.0	1.25	1.5	1.75	2.0	2.5	3.0
Head Height max (K) SS	1.7	2.3	2.8	3.3	4.4	5.5	6.5	7.5	8.5	14.0
Head Dia max (d2)	6	8	10	12	16	20	24	30	36	39
A/F (S)	2	2.5	3	4	5	6	8	10	12	14
Socket Depth Min (t)	1.05	1.49	1.86	2.16	2.85	3.6	4.35	4.89	5.45	10.15

Dimension Standard: ANSI B 18.3

(d1)	#6	#8	#10	1/4	5/16	3/8	7/16	1/2	5/8	3/4
Pitch - UNC	32	32	24	20	18	16	14	13	11	10
Head Height max (K) SS	2.46	2.84	3.23	4.11	5.03	5.94	5.94	6.38	8.23	10.06
Head Dia max (d2)	7.8	9.12	10.44	13.49	16.66	19.84	21.44	23.80	29.97	36.53
A/F (S)	5/64	3/32	1/8	5/32	3/16	7/32	1/4	5/16	3/8	1/2
Socket Depth Min (t)	1.68	1.93	2.21	2.82	3.43	4.04	4.04	4.37	5.59	5.59

Socket Set Screw

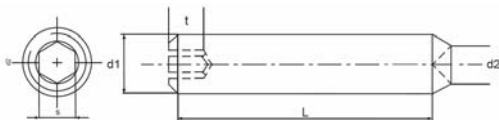

Tolerances	ISO 4759 & ISO 286-2
Threads	6g-ISO 965
Material	AISI 304, 316; Class 4.6, 8.8, 10.9, 12.9
Length (L)	4 to 150 mm

Dimension Specification: DIN 916 / ISO 4029

(d1)	M3	M4	M5	M6	M8	M10	M12	M16	
Cu Dia (d2)	1.15 - 1.4	1.75 - 2	2.25 - 2.5	2.75 - 3	4.7 - 5	5.7 - 6	7.64 - 8	9.64 - 10	
A/F (S)	1.5	2.75	2.5	3	4	5	6	8	
(t) min	lower Limit	1.2	1.5	2	2	3	4	4.8	6.4
	upper Limit	2	2.5	3	3.5	5	6	8	10
Threads	6g	6g	6g	6g	6g	6g	6g	6g	

Hexagon Head Screw

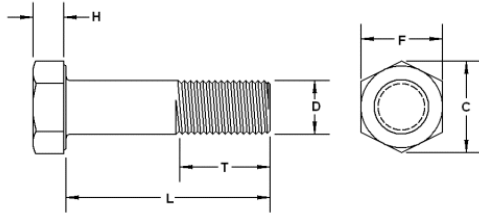

Tolerances	ISO 4759 & ISO 286-2
Threads	6g - ISO 965
Material	AISI 304, 316; GR 5, 8; Class 4.6, 8.8, 10.9
Length (L)	5 to 250 mm

Dimension Specification: DIN 931 & 933

(D)	M3	M4	M5	M6	M8	M10	M12	M16	M20	M24
Head Height (H)	2	2.8	3.5	4	5.3	6.4	7.5	10	13.5	15.5
A/F (F) max	5.5	7	8	10	13	17	19	24	30	36
Across Corner (C)	6.01	7.66	8.79	11.05	14.38	18.90	21.10	26.75	34.6	41.6

Standard Thread Length (T): Bolt lengths <= 150 mm = (2 X D) + 6.35 mm
 Bolt lengths > 150 mm = (2 X D) + 12.7 mm

Dimension Specification: B18.2.1

(D)	3/16"	1/4"	5/16"	3/8"	1/2"	5/8"	3/4"	1"
Head Height (H)	2.85	4.72	5.79	6.86	9.22	11.35	13.46	17.93
A/F (F) max	8.00	11.30	13.34	15.24	20.83	25.64	30.48	37.59
Across Corner (C)	8.16	11.21	13.24	15.14	20.72	25.53	36.65	47.65

Standard Thread Length (T): Bolt lengths <= 6" = (2 X D) + 1/4"
 Bolt lengths > 6" = (2 X D) + 1/2"

Slotted Cheese Head Screw

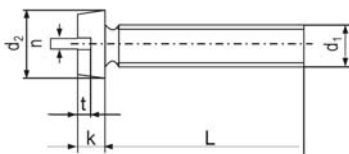

Tolerances	ISO 4759 & ISO 286-2
Threads	6g-ISO 965
Material	AISI 304; Class 4.6
Length (L)	5 to 100 mm

Dimension Specification: DIN 84 / ISO 1207

(d1)	M2	M2.5	M3	M4	M5	M6	M8	M10
Head Height (K)	3.8	4.5	5.5	7	8.5	10	13	16
A/F (S)	1.3	1.6	2	2.6	3.3	3.9	5	6
Across Corner (e)	0.5	0.6	0.8	1.2	1.2	1.6	2	2.5
Pitch	0.4	0.45	0.5	0.7	0.8	1.0	1.25	1.5

Slotted CSK Screw

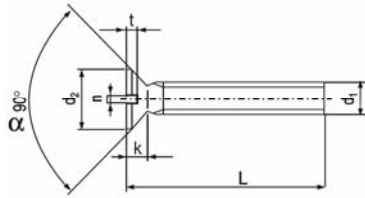

Tolerances	ISO 4759 & ISO 286-2
Threads	6g-ISO 965
Material	AISI 304; Class 4.6
Length (L)	5 to 100 mm

Dimension Specification: DIN 963A / ISO 2009

(d1)	M2	M2.5	M3	M4	M5	M6	M8	M10
Head Dia (d2)	3.8	4.7	5.6	7.5	9.2	11	14.5	18
Head Height (K)	1.2	1.5	1.65	2.2	2.5	3	4	5
Slot Width (n)	0.5	0.6	0.8	1	1.2	1.6	2	2.5
Slot Depth min (t)	0.4	0.5	0.6	0.8	1	1.2	1.6	2
Threads	6g	6g	6g	6g	6g	6g	6g	6g
Angle (α)	90	90	90	90	90	90	90	90

Phillips Pan Head Screw

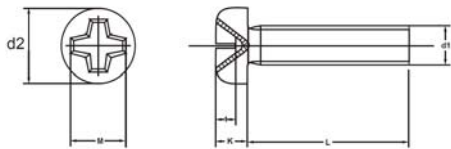

Tolerances	ISO 4759 & ISO 286-2
Threads	6g-ISO 965
Material	AISI 304, Class 4.6
Length (L)	5 to 100 mm

Dimension Specification: DIN 7985/ISO 7045

(d1)	M2	M2.5	M3	M4	M5	M6	M8
Head Dia max (d2)	4	5	6	8	10	12	16
Head Height max (K)	1.72	2.12	2.52	3.25	3.95	4.75	6.15
M	2.5	2.7	3.1	4.6	5.3	6.8	9
Phillips	1	1	1	2	2	3	4
(t) min	1.1	1.3	1.7	2.04	2.77	3.03	4.18
(t) max	1.4	1.6	2	2.54	3.27	3.53	4.68
Threads	6g	6g	6g	6g	6g	6g	6g

Phillips CSK Screw

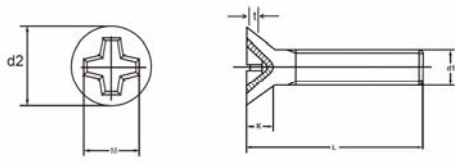

Tolerances	ISO 4759 & ISO 286-2
Threads	6g-1ISO 965
Material	AISI 304; Class 4.6
Length (L)	5 to 100 mm

Dimension Specification: DIN 965A/ISO 7046

(d1)	M2	M2.5	M3	M4	M5	M6	M8
Head Dia max (d2)	3.8	4.7	5.6	7.5	9.2	11	14.5
Head Height max (K)	1.2	1.5	1.65	2.2	2.5	3	4
M	2.35	2.7	2.9	4.4	4.6	6.6	8.7
Philips	1	1	1	2	2	3	4
(t) min	0.95	1.25	1.5	1.9	2.1	2.8	3.9
(t) max	1.25	1.55	1.8	2.4	2.6	3.3	4.4
Threads	6g	6g	6g	6g	6g	6g	6g

Self Tapping CSK Phillips Screw

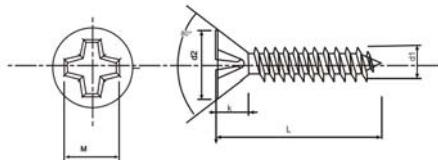

Tolerances	ISO 4759 & ISO 286-2
Material	AISI 304; Class 4.6
Length (L)	1/4" to 4"

Dimension Specification: DIN 7982 / ISO 7050

(d1)	ST 2.2 ⁽²⁾	ST 2.9 ⁽⁴⁾	ST 3.5 ⁽⁶⁾	ST 4.2 ⁽⁸⁾	ST 4.8 ⁽¹⁰⁾	ST 5.5 ⁽¹²⁾	ST 6.3 ⁽¹⁴⁾
Head Dia max (d2)	4.3	5.5	6.8	8.1	9.5	10.8	12.4
Head Height max (k)	1.3	1.7	2.1	2.5	3	3.4	3.8
Philips	1	1	2	2	2	3	3
M	2.5	3	4.2	4.7	5.1	6.8	7.1

Self Tapping Pan Phillips Screw

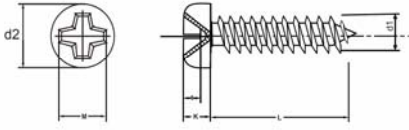

Tolerances	ISO 4759 & ISO 286-2
Material	AISI 304; Class 4.6
Length (L)	1/4" to 4"

Dimension Specification: DIN 7981 / ISO 7049

(d1)	ST 2.2 ⁽²⁾	ST 2.9 ⁽⁴⁾	ST 3.5 ⁽⁶⁾	ST 4.2 ⁽⁸⁾	ST 4.8 ⁽¹⁰⁾	ST 5.5 ⁽¹²⁾	ST 6.3 ⁽¹⁴⁾
Head Dia max (d2)	4.2	5.6	6.9	8.2	9.5	10.8	12.5
Head Height max (K)	1.8	2.2	2.6	3.05	3.55	3.95	4.55
Philips	1	1	2	2	2	3	3
M	2.6	3	4.2	4.6	5	6.5	7.1

Hex Nut

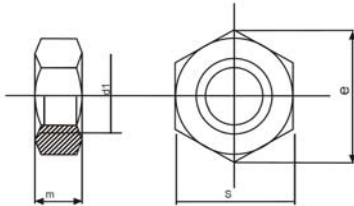

Tolerances	ISO 4759/DIN 267
Threads	6g-1SO 965
Material	AISI 304, 316; GR 5, 8; Brass

Dimension Specification: DIN 934

(d1)	M2	M2.5	M3	M4	M5	M6	M8	M10	M12	M16
A/F (S)	4	5	5.5	7	8	10	13	17	19	24
A/C Main (e)	4.32	5.45	6.01	7.66	8.79	11.05	14.38	18.9	21.1	26.75
Head Height max (M)	1.6	2	2.4	3.2	4	5	6.5	8	10	13

(d1)	1/4"	5/16"	3/8"	1/2"	5/8"	3/4"	1"
A/F (S) max	11.13	12.7	14.27	19.05	23.83	28.58	38.10
A/C (e) max	12.83	14.66	16.51	22.00	27.50	33.00	43.99
Head Height (M) max	5.74	6.93	8.56	11.86	14.20	16.89	22.53

Lock Nut

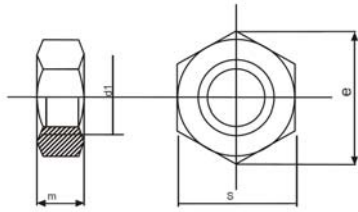

Tolerances	ISO 4759/DIN 267
Threads	6g-1SO 965
Material	AISI 304, 316; GR 2, 5, 8; Brass

Dimension Specification: DIN 934

(d1)	M2	M2.5	M3	M4	M5	M6	M8	M10	M12	M16
A/F (S)	4	5	5.5	7	8	10	13	17	19	24
A/C Main (e)	4.32	5.45	6.01	7.66	8.79	11.05	14.38	18.9	21.1	26.75
Head Height max (m)	1.2	1.6	1.8	2.2	2.7	3.2	4.0	5	6	8

(d1)	1/4"	5/16"	3/8"	1/2"	5/8"	3/4"	1"
A/F (S) max	11.3	13.33	15.24	20.83	25.65	30.48	38.1
A/C (e) max	12.83	14.66	16.51	22.00	27.50	33.00	43.99
Head Height (m) max	4.17	4.95	5.77	8.20	9.83	11.33	14.61

Hex Weld Nut

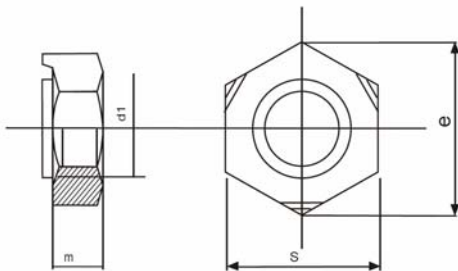

Tolerances	ISO 4759 / DIN 267
Threads	1SO 965
Material	AISI 304; GR 2, 5

Dimension Specification: DIN 929

(d1)	M3	M4	M5	M6	M8	M10
(m)	3	3.5	4	5	6.5	8
(S)	7.5	9	10	11	14	17

Hex Nyloc Nut

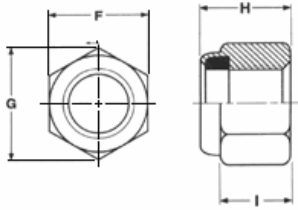

Tolerances	ISO 4759/DIN 267
Threads	6g-1ISO 965
Material	AISI 304, 316; GR 2, 5

Dimension Specification: DIN 934

(D1)	M3	M4	M5	M6	M8	M10	M12	M16
A/F (F)	5.5	7	8	10	13	17	19	24
A/C Main (G)	6.01	7.66	8.79	11.05	14.38	18.9	21.1	26.75
Head Height (H) max	2.4	2.9	3.2	4.0	5.5	6.5	8	10.5

(D1)	1/4"	5/16"	3/8"	1/2"	5/8"	3/4"	1"
A/F (F) max	11.15	12.75	14.35	19.10	23.89	28.63	38.15
A/C Main (G) max	12.25	14.02	15.80	21.26	26.70	30.25	41.02
Head Height (H) max	8.33	9.12	11.19	15.47	19.43	22.61	27.38

Wing Nut

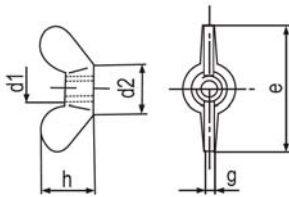

Tolerances	ISO 4759
Threads	6g-1ISO 965
Material	AISI 304; GR 2, 5

Dimension Specification: DIN 315

(d1)	M4	M5	M6	M8	M10	M12	M16
(d2) max	8	11	13	16	20	23	29
(e) max	20	26	33	39	51	65	73
(g) max	1.9	2.3	2.3	2.8	4.4	4.9	6.4
(n) max	10.5	13	17	20	25	33.5	37.5

Plain Washer

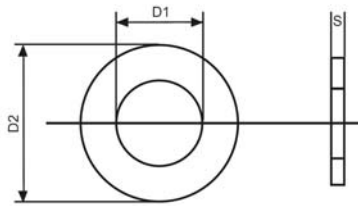

Tolerances	ISO 4759/DIN 267
Material	AISI 304, 316; GR 2

Dimension Specification: DIN 125A / ISO 7089

	M2	M2.5	M3	M4	M5	M6	M8
Internal Dia (D1)	2.2	2.7	3.2	4.3	5.3	6.4	8.4
External Dia (D2)	5	6	7	9	10	12	16
Thickness (S)	0.3	0.5	0.5	0.8	1	1.6	1.6
	M10	M12	M16	M20	M24	M30	
Internal Dia (D1)	10.5	13	17	21	25	31	
External Dia (D2)	20	24	30	37	44	56	
Thickness (S)	2	2.5	3	3	4	4	

Spring Washer

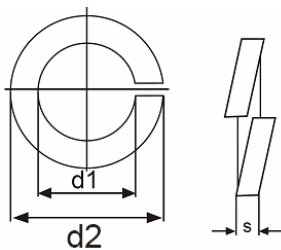

Tolerances	ISO 4759/DIN 267
Material	AISI 304, 316; Spring Steel
Type	A & B

Dimension Specification: DIN 127B

	M2	M2.5	M3	M4	M5	M6	M8
Internal Dia (d1)	2.1/2.4	2.6/2.9	3.1/3.4	4.1/4.4	5.1/5.4	6.1/6.5	8.1/8.5
External Dia (d2)	4.4	5.1	6.2	7.6	9.2	11.8	14.8
Thickness (S)	0.5	0.6	0.8	0.9	1.2	1.6	2
	M10	M12	M16	M20	M24	M30	
Internal Dia (d1)	10.2/10.7	12.2/12.7	16.2/17	20.2/21.2	24.5/25.5	30.5/31.7	
External Dia (d2)	18.1	21.1	27.4	33.6	40	48.2	
Thickness (S)	2.2	2.5	3.5	4	5	6	